

FOR NPS USE ONLY
RECEIVED
DATE ENTERED

# NATIONAL REGISTER OF HISTORIC PLACES INVENTORY -- NOMINATION FORM

SEE INSTRUCTIONS IN HOW TO COMPLETE NATIONAL REGISTER FORMS  
TYPE ALL ENTRIES -- COMPLETE APPLICABLE SECTIONS

## 1 NAME

HISTORIC Mt. Pulaski Courthouse

AND/OR COMMON

## 2 LOCATION

STREET & NUMBER Public Square

--- NOT FOR PUBLICATION

CITY, TOWN

Mt. Pulaski

--- VICINITY OF

21st

CONGRESSIONAL DISTRICT

STATE

Illinois

CODE

17

COUNTY

Logan

CODE

107

## 3 CLASSIFICATION

CATEGORY	OWNERSHIP	STATUS	PRESENT USE
<input type="checkbox"/> DISTRICT	<input checked="" type="checkbox"/> PUBLIC	<input checked="" type="checkbox"/> OCCUPIED	<input type="checkbox"/> AGRICULTURE <input checked="" type="checkbox"/> MUSEUM
<input checked="" type="checkbox"/> BUILDING(S)	<input type="checkbox"/> PRIVATE	<input type="checkbox"/> UNOCCUPIED	<input type="checkbox"/> COMMERCIAL <input type="checkbox"/> PARK
<input type="checkbox"/> STRUCTURE	<input type="checkbox"/> BOTH	<input type="checkbox"/> WORK IN PROGRESS	<input type="checkbox"/> EDUCATIONAL <input type="checkbox"/> PRIVATE RESIDENCE
<input type="checkbox"/> SITE	<b>PUBLIC ACQUISITION</b>	<b>ACCESSIBLE</b>	<input type="checkbox"/> ENTERTAINMENT <input type="checkbox"/> RELIGIOUS
<input type="checkbox"/> OBJECT	<input type="checkbox"/> IN PROCESS	<input type="checkbox"/> YES, RESTRICTED	<input type="checkbox"/> GOVERNMENT <input type="checkbox"/> SCIENTIFIC
	<input type="checkbox"/> BEING CONSIDERED	<input checked="" type="checkbox"/> YES, UNRESTRICTED	<input type="checkbox"/> INDUSTRIAL <input type="checkbox"/> TRANSPORTATION
		<input type="checkbox"/> NO	<input type="checkbox"/> MILITARY <input type="checkbox"/> OTHER:

## 4 OWNER OF PROPERTY

NAME Illinois Department of Conservation

STREET & NUMBER

605 State Office Building

CITY, TOWN

Springfield

--- VICINITY OF

Illinois

STATE

## 5 LOCATION OF LEGAL DESCRIPTION

COURTHOUSE,  
REGISTRY OF DEEDS, ETC.

Logan County Courthouse

STREET & NUMBER

CITY, TOWN

Lincoln

Illinois

STATE

## 6 REPRESENTATION IN EXISTING SURVEYS

TITLE

Illinois Historic Sites Survey

DATE

1973

--- FEDERAL  STATE --- COUNTY --- LOCAL

DEPOSITORY FOR  
SURVEY RECORDS

Div. of Historic Sites, Ill. Dept. of Conservation

CITY, TOWN

Springfield

Illinois

STATE

# DESCRIPTION

CONDITION		CHECK ONE	CHECK ONE
<input checked="" type="checkbox"/> EXCELLENT	<input type="checkbox"/> DETERIORATED	<input checked="" type="checkbox"/> UNALTERED	<input checked="" type="checkbox"/> ORIGINAL SITE
<input type="checkbox"/> GOOD	<input type="checkbox"/> RUINS	<input type="checkbox"/> ALTERED	<input type="checkbox"/> MOVED DATE _____
<input type="checkbox"/> FAIR	<input type="checkbox"/> UNEXPOSED		

DESCRIBE THE PRESENT AND ORIGINAL (IF KNOWN) PHYSICAL APPEARANCE

The Mt. Pulaski Courthouse represents the typically midwestern courthouse of the mid-nineteenth century. The structure is a Greek Revival rectangular block placed on the highest point of the public square and faced west. It is raised one-half story in temple fashion. Bilateral symmetry is strong. The low-pitched roof has a front-to-back ridge ending in plain but complete, building-wide pediments. Three plain chimneys rise on each side of the ridge. Pilasters dominate each corner. A first-floor string course circles the building. No vegetation obscures the bases of the walls. The building is of brick and frame construction, about 25 x 30 feet in size. All the wood trim is white.

The west (front) facade is dominated by the clean, white pediment and cornice. The facade boasts five 6/6 double-hung windows. The steps are wood, angled up to, the solid, double white wood doors. The doors are flanked by five-pane sidelights and topped with a four-pane transom, each pane rectangular. White pilasters and cornice surround the door. The east (rear) facade is similar to the front except for the diminutive single door. The fenestration of the north and south facades is symmetrical with six windows, outlined by the cornice and corner pilasters.

The first floor consists of a central hall with front and rear entrances. Six offices, three to each side, are furnished in period furnishings and reproductions of Franklin stoves believed to be similar to those in the original building. The interior is white with gray trim and with little ornamentation, continuing the simple rectangular forms of the exterior. The second floor is comprised of the courtroom, the jury room and the judges' chambers. Also, with the period furnishings, the courtroom boasts the original oak floor boards, discovered during restoration.

In the restoration work the State removed partitions put in the building over the years, took down a cupola and bell that had been erected when the building served as a schoolhouse, and restored the front door to its original appearance. On removing the flooring on the second floor, the original flooring was found to be intact. Gradually the historians have found furniture used in this period and once again the building appears as it did in Lincoln's day, including most of the law books and the gavel used by Judge David Davis when he held court there.

**SIGNIFICANCE**

PERIOD	AREAS OF SIGNIFICANCE -- CHECK AND JUSTIFY BELOW				
<input type="checkbox"/> PREHISTORIC	<input type="checkbox"/> ARCHEOLOGY-PREHISTORIC	<input type="checkbox"/> COMMUNITY PLANNING	<input type="checkbox"/> LANDSCAPE ARCHITECTURE	<input type="checkbox"/> RELIGION	
<input type="checkbox"/> 1400-1499	<input type="checkbox"/> ARCHEOLOGY-HISTORIC	<input type="checkbox"/> CONSERVATION	<input type="checkbox"/> LAW	<input type="checkbox"/> SCIENCE	
<input type="checkbox"/> 1500-1599	<input type="checkbox"/> AGRICULTURE	<input type="checkbox"/> ECONOMICS	<input type="checkbox"/> LITERATURE	<input type="checkbox"/> SCULPTURE	
<input type="checkbox"/> 1600-1699	<input checked="" type="checkbox"/> ARCHITECTURE	<input type="checkbox"/> EDUCATION	<input type="checkbox"/> MILITARY	<input type="checkbox"/> SOCIAL/HUMANITARIAN	
<input type="checkbox"/> 1700-1799	<input type="checkbox"/> ART	<input type="checkbox"/> ENGINEERING	<input type="checkbox"/> MUSIC	<input type="checkbox"/> THEATER	
<input checked="" type="checkbox"/> 1800-1899	<input type="checkbox"/> COMMERCE	<input type="checkbox"/> EXPLORATION/SETTLEMENT	<input type="checkbox"/> PHILOSOPHY	<input type="checkbox"/> TRANSPORTATION	
<input type="checkbox"/> 1900-	<input type="checkbox"/> COMMUNICATIONS	<input type="checkbox"/> INDUSTRY	<input checked="" type="checkbox"/> POLITICS/GOVERNMENT	<input type="checkbox"/> OTHER (SPECIFY)	
		<input type="checkbox"/> INVENTION			

SPECIFIC DATES      1847

BUILDER/ARCHITECT

## STATEMENT OF SIGNIFICANCE

The Mt. Pulaski Courthouse offers significant contributions to the areas of architecture and politics/government. Architecturally the structure represents an intact example of small-scale Greek Revival architecture as adapted for many public buildings. Important characteristics include the rectangular block form, the classical pediments and pilasters, the low, front-to-rear roof ridge, the trabeated windows and the infrequent ornamentation. One architectural historian has observed that "this diminutive Grecian courthouse at Mt. Pulaski ranks among the finest and best-preserved pre-1850 buildings in the state. It shows how well the Greek Revival style could be adapted to give elegance and sophistication to so small and inexpensive a governmental building" (See Bibliographical References).

The use of the structure as the Logan County Courthouse for the years 1848 to 1853 qualifies it as important in politics and government. The building sits high atop the surrounding city and countryside, emphasizing the high ideals of the government to be contained within its walls. The building served as part of the old Eighth Judicial Circuit and therefore attracted such important figures as Abraham Lincoln, Stephen A. Douglas, David Davis, and Robert J. Ingersoll.

History

Postville had been the original seat of government in Logan County from 1840 to 1848. In 1847, the citizens of Mt. Pulaski successfully organized an effort to have the county seat moved. To build the new courthouse local citizens raised \$2700 to add to the \$300 county appropriation. The building served as a county courthouse for only five years beginning in 1848 for in 1853 the county seat was again moved, this time to Lincoln, which is more centrally located in the county. The old courthouse at Mt. Pulaski subsequently served as a schoolhouse, then a city hall and jail, and finally as a post office and headquarters for various local town officials. In 1936, the State of Illinois purchased the building and commenced restoration work in 1938.

# MAJOR BIBLIOGRAPHICAL REFERENCES

Sprague, Paul E. "Mt. Pulaski Courthouse," Outdoor Illinois, (Jan., 1974)  
 State of Illinois, Department of Conservation, Division of Parks  
 and Memorials, "Mt. Pulaski Courthouse State Memorial,"  
 Pamphlet No. 25M-5-73.  
 State of Illinois, Department of Conservation, Division of Lands and  
 Historic Sites, Files.

# GEOGRAPHICAL DATA

ACREAGE OF NOMINATED PROPERTY Less than one

UTM REFERENCES

A |     |     |     |     |     |     |     |     |     |     |     |     |     |     |  
 ZONE EASTING NORTHING  
 C |     |     |     |     |     |     |     |     |     |     |     |     |     |

B |     |     |     |     |     |     |     |     |     |     |     |     |     |     |  
 ZONE EASTING NORTHING  
 D |     |     |     |     |     |     |     |     |     |     |     |     |     |

VERBAL BOUNDARY DESCRIPTION

UTM references not available

Latitude 40° 00' 34"  
 Longitude 89° 17' 10"

LIST ALL STATES AND COUNTIES FOR PROPERTIES OVERLAPPING STATE OR COUNTY BOUNDARIES

STATE	CODE	COUNTY	CODE
STATE	CODE	COUNTY	CODE

# FORM PREPARED BY

NAME / TITLE Patrick J. Glithero, Director

ORGANIZATION Logan County Planning Commission

DATE March 17, 1977

STREET & NUMBER 529 South Mc Lean Street

TELEPHONE 217/732-8835

CITY OR TOWN Lincoln

STATE Illinois

# STATE HISTORIC PRESERVATION OFFICER CERTIFICATION

THE EVALUATED SIGNIFICANCE OF THIS PROPERTY WITHIN THE STATE IS:

NATIONAL     

STATE   X  

LOCAL     

As the designated State Historic Preservation Officer for the National Historic Preservation Act of 1966 (Public Law 89-665), I hereby nominate this property for inclusion in the National Register and certify that it has been evaluated according to the criteria and procedures set forth by the National Park Service.

STATE HISTORIC PRESERVATION OFFICER SIGNATURE

TITLE Director, Illinois Department of Conservation DATE

FOR NPS USE ONLY

I HEREBY CERTIFY THAT THIS PROPERTY IS INCLUDED IN THE NATIONAL REGISTER

DATE

DIRECTOR, OFFICE OF ARCHEOLOGY AND HISTORIC PRESERVATION  
 ATTEST:

DATE

KEEPER OF THE NATIONAL REGISTER

UNITED STATES DEPARTMENT OF THE INTERIOR  
NATIONAL PARK SERVICE

NATIONAL REGISTER OF HISTORIC PLACES  
INVENTORY -- NOMINATION FORM

FOR NPS USE ONLY

RECEIVED

DATE ENTERED

CONTINUATION SHEET

ITEM NUMBER

PAGE

First Floor

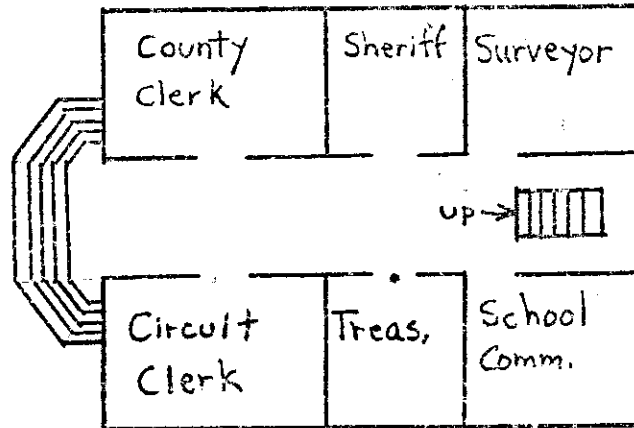

Second Floor

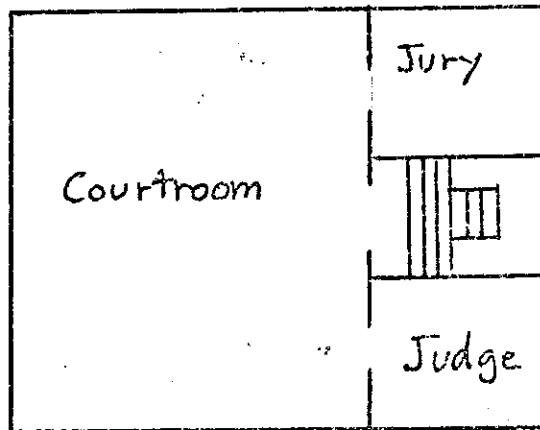

ENTRIES IN THE NATIONAL REGISTER

ILLINOIS

STATE

Date Entered      AUG 3 1978

<u>Name</u>	<u>Location</u>
Mt. Pulaski Courthouse	Mt. Pulaski Logan County

Also Notified

Honorable Charles H. Percy  
Honorable Adlai E. Stevenson  
Honorable Edward R. Madigan

**COPY OF CONGRESSIONAL NOTIFICATION**

ILLINOIS HISTORIC SITES SURVEY INVENTORY

1. Name of Site:

Common Mt. Pulaski Courthouse and Markers  
Historic

2. Location:

Street and Number Township Section  
Courthouse square 18N 14  
City or Town Zip Code Range ¼ Section  
Mt. Pulaski 2W SW  
County  
Logan

3. Classification:

Category (check one) Integrity (check one)  
( ) District ( ) Building ( ) Altered (x) Unaltered  
( ) Site (x) Structure ( ) Moved (x) Original Site

4. Ownership:

( ) Private (xx) Occupied  
(x) Public ( ) Unoccupied  
(x) Preservation work in progress

Access to Public

(x) Yes ( ) Restricted (x) Unrestricted ( ) No

Present Use (check one or more)

( ) Agricultural ( ) Industrial ( ) Religious  
( ) Commercial ( ) Military ( ) Scientific  
( ) Educational (x) Museum ( ) Transportation  
( ) Entertainment ( ) Park ( ) Other (specify)  
( ) Government ( ) Private Residence

5. Ownership of Property:

Owner's Name Phone Number  
Street and Number  
City or Town  
State County Zip Code

6. Description:

Condition:

(x) Excellent ( ) Good ( ) Fair ( ) Deteriorated ( ) Ruins  
( ) Unexposed

Is there a program of preservation underway? (x) Yes ( ) No

GOVERNMENT

