

NATIONAL REGISTER OF HISTORIC PLACES  
INVENTORY - NOMINATION FORM

(Type all entries - complete applicable sections)

STATE: <b>Illinois</b>
COUNTY: <b>Randolph</b>
FOR NPS USE ONLY
ENTRY DATE

**1. NAME**

COMMON:  
**Kolmer Site**

AND/OR HISTORIC:  
**Michigamea Village**

**2. LOCATION**

STREET AND NUMBER:

CITY OR TOWN:  
**Prairie du Rocher**

CONGRESSIONAL DISTRICT:

STATE:  
**Illinois**

CODE:  
**17**

COUNTY:  
**Randolph**

CODE:  
**157**

**3. CLASSIFICATION**

CATEGORY (Check One)	OWNERSHIP	STATUS	ACCESSIBLE TO THE PUBLIC
<input type="checkbox"/> District <input checked="" type="checkbox"/> Site <input type="checkbox"/> Building <input type="checkbox"/> Structure <input type="checkbox"/> Object	<input type="checkbox"/> Public <input checked="" type="checkbox"/> Private <input type="checkbox"/> Both	Public Acquisition: <input type="checkbox"/> In Process <input type="checkbox"/> Being Considered	<input checked="" type="checkbox"/> Occupied <input type="checkbox"/> Unoccupied <input type="checkbox"/> Preservation work in progress
PRESENT USE (Check One or More as Appropriate)			
<input checked="" type="checkbox"/> Agricultural <input type="checkbox"/> Commercial <input type="checkbox"/> Educational <input type="checkbox"/> Entertainment	<input type="checkbox"/> Government <input type="checkbox"/> Industrial <input type="checkbox"/> Military <input type="checkbox"/> Museum	<input type="checkbox"/> Park <input type="checkbox"/> Private Residence <input type="checkbox"/> Religious <input type="checkbox"/> Scientific	<input type="checkbox"/> Transportation <input type="checkbox"/> Other (Specify)
Yes: <input type="checkbox"/> Restricted <input type="checkbox"/> Unrestricted <input checked="" type="checkbox"/> No			

**4. OWNER OF PROPERTY**

OWNER'S NAME:  
**Otto Kolmer**

STREET AND NUMBER:

CITY OR TOWN:  
**Prairie du Rocher**

STATE:  
**Illinois**

CODE:  
**17**

**5. LOCATION OF LEGAL DESCRIPTION**

COURTHOUSE, REGISTRY OF DEEDS, ETC.:  
**Courthouse, Chester**

STREET AND NUMBER:

CITY OR TOWN:  
**Chester**

STATE:  
**Illinois**

CODE:  
**17**

**6. REPRESENTATION IN EXISTING SURVEYS**

TITLE OF SURVEY:  
**Illinois Archeological Survey**

DATE OF SURVEY:  Federal  State  County  Local

DEPOSITORY FOR SURVEY RECORDS:  
**109 Davenport Hall, University of Illinois**

STREET AND NUMBER:

CITY OR TOWN:  
**Urbana**

STATE:  
**Illinois**

CODE:  
**17**

SEE INSTRUCTIONS

24th Congressional District - Congressman: Kenneth Grey

STATE: <b>Illinois</b>
COUNTY: <b>Randolph</b>
FOR NPS USE ONLY
ENTRY NUMBER
DATE

**7. DESCRIPTION**

CONDITION

- |   |  |                               |                                       |                                |   |
|---|--|-------------------------------|---------------------------------------|--------------------------------|---|
| <input type="checkbox"/> Excellent          | <input checked="" type="checkbox"/> Good | <input type="checkbox"/> Fair | <input type="checkbox"/> Deteriorated | <input type="checkbox"/> Ruins | <input type="checkbox"/> Unexposed                |
| (Check One)                                 |  |                               |                                       |                                |   |
| (Check One)                                 |  |                               |                                       |                                |   |
| <input checked="" type="checkbox"/> Altered | <input type="checkbox"/> Unaltered       |                               |                                       | <input type="checkbox"/> Moved | <input checked="" type="checkbox"/> Original Site |
|   |  | (Check One)                   |                                       |                                |   |

DESCRIBE THE PRESENT AND ORIGINAL (If known) PHYSICAL APPEARANCE

The land is presently farm land, mixed gumbo and sandy humus. Area is on former bank of the Mississippi, the channel being occupied by the river at the time the site was in use. The area is slightly undulating with one fairly deep wash that may not have been present originally.

The village was originally surrounded by a stockade and had approximately 1200 inhabitants.

SEE INSTRUCTIONS

**3. SIGNIFICANCE**

PERIOD (Check One or More as Appropriate)

<input type="checkbox"/> Pre-Columbian	<input type="checkbox"/> 16th Century	<input checked="" type="checkbox"/> 18th Century	<input type="checkbox"/> 20th Century
<input type="checkbox"/> 15th Century	<input type="checkbox"/> 17th Century	<input type="checkbox"/> 19th Century	

SPECIFIC DATE(S) (If Applicable and Known) **1720-1752**

AREAS OF SIGNIFICANCE (Check One or More as Appropriate)

<input type="checkbox"/> Aboriginal	<input type="checkbox"/> Education	<input type="checkbox"/> Political	<input type="checkbox"/> Urban Planning
<input type="checkbox"/> Prehistoric	<input type="checkbox"/> Engineering	<input type="checkbox"/> Religion/Philosophy	<input type="checkbox"/> Other (Specify) _____
<input checked="" type="checkbox"/> Historic	<input type="checkbox"/> Industry	<input type="checkbox"/> Science	_____
<input type="checkbox"/> Agriculture	<input type="checkbox"/> Invention	<input type="checkbox"/> Sculpture	_____
<input type="checkbox"/> Architecture	<input type="checkbox"/> Landscape Architecture	<input type="checkbox"/> Social/Humanitarian	_____
<input type="checkbox"/> Art	<input type="checkbox"/> Literature	<input type="checkbox"/> Theater	_____
<input type="checkbox"/> Commerce	<input type="checkbox"/> Military	<input type="checkbox"/> Transportation	_____
<input type="checkbox"/> Communications	<input type="checkbox"/> Music		
<input type="checkbox"/> Conservation			

STATEMENT OF SIGNIFICANCE

In 1720 the first Indian reservation in the country was created for the Michigamea Indians, a group of the Illinois, by the French. The Michigamea lived on this reserve until they left the area in the 1770's. The Kolmer Site is the first village they occupied and dates from 1720 to 1752. In 1752 the village was attacked by Fox, Sioux, Chippewa and other northern tribes and many of the Michigamea were massacred or captured. The Fox burned the village. This carefully planned sneak attack terrified the Indians and they fled to the town of Kaskaskia. When they returned they built a new village at a different location on the reserve (the waterman site, R122). The Kolmer village was built shortly after the Michigamea had come into direct contact with the French and it covers a fairly short time span. The village was burned and not reoccupied; because of this it can be expected that much material was left in situ by the fleeing Indians. This material would have great potential for the study of the contact situation between the French and Indians and for study of change in the Indian culture. Because of the close dating the site could provide good information for the dating of French trade materials. Being the first village on this historic reserve and the site of the first major attack of the northern Indians on the Illinois in southern Illinois, it has significance in the early history of the state.

SEE INSTRUCTIONS

**9. MAJOR BIBLIOGRAPHICAL REFERENCES**

d' Artagiette 1722 in Mereness, Newton D. 1916. Travels in the American Colonies. MacMillian, Co. N. Y.

Bossu, N. 1771 Travels through that part of North America formerly called Louisiana. Trans. John Forster. T. Davies London.

**10. GEOGRAPHICAL DATA**

LATITUDE AND LONGITUDE COORDINATES DEFINING A RECTANGLE LOCATING THE PROPERTY				O R	LATITUDE AND LONGITUDE COORDINATES DEFINING THE CENTER POINT OF A PROPERTY OF LESS THAN TEN ACRES							
CORNER	LATITUDE				LONGITUDE			LATITUDE		LONGITUDE		
	Degrees	Minutes	Seconds	Degrees	Minutes	Seconds	Degrees	Minutes	Seconds	Degrees	Minutes	Seconds
NW	38°	05'	41"	90°	11'	04"						
NE	38°	05'	41"	90°	10'	38"						
SE	38°	05'	19"	90°	11'	04"						
SW	38°	05'	19"	90°	10'	38"						

APPROXIMATE ACREAGE OF NOMINATED PROPERTY: 89.0

LIST ALL STATES AND COUNTIES FOR PROPERTIES OVERLAPPING STATE OR COUNTY BOUNDARIES

STATE:	CODE	COUNTY	CODE

**11. FORM PREPARED BY**

NAME AND TITLE:

Margaret Kimball Brown

ORGANIZATION

Northwestern University

DATE

STREET AND NUMBER:

1007 Dempster

CITY OR TOWN:

Evanston

STATE

Illinois

CODE

17

**12. STATE LIAISON OFFICER CERTIFICATION**

As the designated State Liaison Officer for the National Historic Preservation Act of 1966 (Public Law 89-665), I hereby nominate this property for inclusion in the National Register and certify that it has been evaluated according to the criteria and procedures set forth by the National Park Service. The recommended level of significance of this nomination is:

National  State  Local

Name

*Margaret Kimball Brown*  
Director, Illinois Department of Conservation / State Historic Preservation Officer

Date

September 4, 1973

**NATIONAL REGISTER VERIFICATION**

I hereby certify that this property is included in the National Register.

\_\_\_\_\_  
Director, Office of Archeology and Historic Preservation

Date

ATTEST:

\_\_\_\_\_  
Keeper of The National Register

Date

SEE INSTRUCTIONS



UNITED STATES DEPARTMENT OF THE INTERIOR  
NATIONAL PARK SERVICE

**NATIONAL REGISTER OF HISTORIC PLACES  
PROPERTY PHOTOGRAPH FORM**

*(Type all entries - attach to or enclose with photograph)*

STATE <b>Illinois</b>	
COUNTY <b>Randolph</b>	
FOR NPS USE ONLY	
ENTRY NUMBER	DATE

SEE INSTRUCTIONS

<b>1. NAME</b>			
COMMON: <b>Kolmer Site</b>			
AND/OR HISTORIC: <b>Michigamea Village</b>			
<b>2. LOCATION</b>			
STREET AND NUMBER:			
CITY OR TOWN: <b>Prairie du Rocher</b>			
STATE: <b>Illinois</b>		CODE <b>17</b>	COUNTY: <b>Randolph</b>
			CODE <b>157</b>
<b>3. PHOTO REFERENCE</b>			
PHOTO CREDIT: <b>Irv Piethman</b>			
DATE OF PHOTO: <b>August 1973</b>			
NEGATIVE FILED AT: <b>Illinois Historic Landmarks Survey, 320 South Main St., Benton, Illinois</b>			
<b>4. IDENTIFICATION</b>			
DESCRIBE VIEW, DIRECTION, ETC.  <b>Showing entire site from Southeast.</b>			

BLOOMSDALE QUADRANGLE  
 MISSOURI--ILLINOIS  
 7.5 MINUTE SERIES (TOPOGRAPHIC)  
 SW 1/4 RENAUULT 15' QUADRANGLE

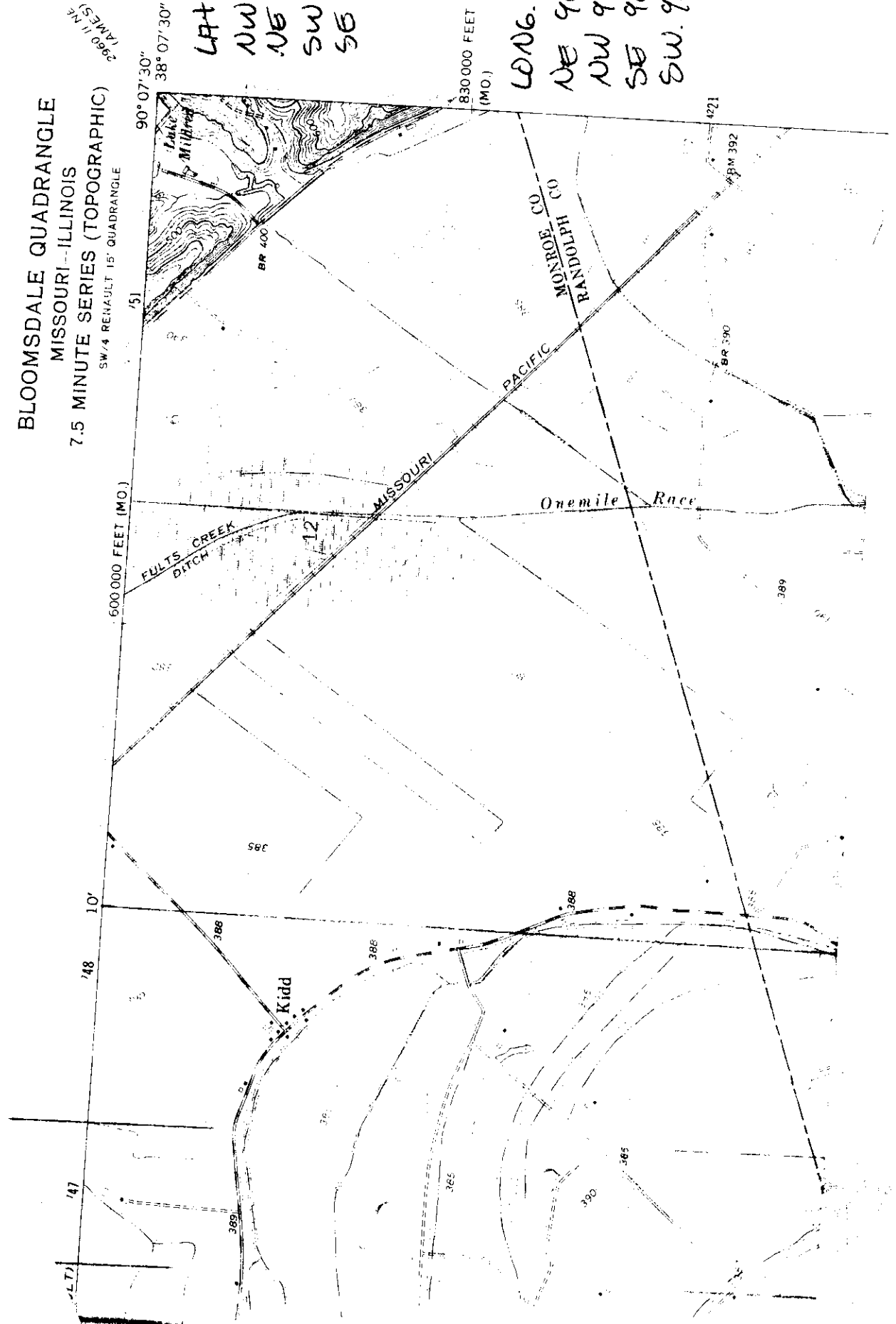

2960 11 NE  
 (AMES)

90° 07' 30"  
 38° 07' 30"

LAT  
 NW 38° 05' 41"  
 NE 38° 05' 41"  
 SW 38° 05' 19"  
 SE 38° 05' 19"

830,000 FEET  
 (MO.)

LONG.

NE 90° 10' 38"  
 NW 90° 11' 04"  
 SE 90° 10' 38"  
 SW 90° 11' 04"

Form 10-301  
(July 1969)

UNITED STATES DEPARTMENT OF THE INTERIOR  
NATIONAL PARK SERVICE

NATIONAL REGISTER OF HISTORIC PLACES  
PROPERTY MAP FORM

(Type all entries - attach to or enclose with map)

STATE	
Illinois	
COUNTY	
Randolph	
FOR NPS USE ONLY	
ENTRY NUMBER	DATE

SEE INSTRUCTIONS

<b>1. NAME</b>			
COMMON: <b>Kolmer Site</b>			
AND/OR HISTORIC: <b>Michigamea Village</b>			
<b>2. LOCATION</b>			
STREET AND NUMBER:			
CITY OR TOWN: <b>Prairie du Rocher</b>			
STATE:	CODE	COUNTY:	CODE
<b>Illinois</b>	<b>17</b>	<b>Randolph</b>	<b>157</b>
<b>3. MAP REFERENCE</b>			
SOURCE: <b>Bloomsdale Quadrangle</b>			
SCALE: <b>1:24000 7.5'</b>			
DATE:			
<b>4. REQUIREMENTS</b>			
TO BE INCLUDED ON ALL MAPS			
1. Property boundaries where required.			
2. North arrow.			
3. Latitude and longitude reference.			

ENTRIES IN THE NATIONAL REGISTER

STATE ILLINOIS

Date Entered MAY 1 1974

<u>Name</u>	<u>Location</u>
✓ Kolmer Site	Prairie du Rocher Randolph County

**COPY OF CONGRESSIONAL NOTIFICATION**

RECEIVED

Also Notified

Hon. Charles H. Percy  
Hon. Adlai E. Stevenson, III  
Hon. Kenneth J. Gray