

United States Department of the Interior
National Park Service

National Register of Historic Places Registration Form

CLICK HERE for Multiple Property Listing,
"Fraternity and Sorority Houses at the Urbana-
Champaign Campus of the University of Illinois
Multiple Property Submission"

This form is for use in nominating or requesting determinations of eligibility for individual properties or districts. See instructions in *Guidelines for Completing National Register Forms* (National Register Bulletin 16). Complete each item by marking "x" in the appropriate box or by entering the requested information. If an item does not apply to the property being documented, enter "N/A" for "not applicable." For functions, styles, materials, and areas of significance, enter only the categories and subcategories listed in the instructions. For additional space use continuation sheets (Form 10-900a). Type all entries.

1. Name of Property

historic name Phi Mu Sorority House
other names/site number Delta Beta Chapter House of Phi Mu, Le Treinto Student House, Phi Sigma Delta Fraternity House, Beta Sigma Psi Fraternity House

2. Location

street & number 706 West Ohio Street N/A not for publication
city, town Urbana N/A vicinity
state Illinois code IL county Champaign code 019 zip code 61820

3. Classification

Ownership of Property	Category of Property	Number of Resources within Property	
<input checked="" type="checkbox"/> private	<input checked="" type="checkbox"/> building(s)	Contributing	Noncontributing
<input type="checkbox"/> public-local	<input type="checkbox"/> district	<u>1</u>	<u> </u> buildings
<input type="checkbox"/> public-State	<input type="checkbox"/> site	<u> </u>	<u> </u> sites
<input type="checkbox"/> public-Federal	<input type="checkbox"/> structure	<u> </u>	<u> </u> structures
	<input type="checkbox"/> object	<u>1</u>	<u>0</u> Total

Name of related multiple property listing: Fraternity and Sorority Houses at the Urbana-Champaign Campus of the University of Illinois
Number of contributing resources previously listed in the National Register 0

4. State/Federal Agency Certification

As the designated authority under the National Historic Preservation Act of 1966, as amended, I hereby certify that this nomination request for determination of eligibility meets the documentation standards for registering properties in the National Register of Historic Places and meets the procedural and professional requirements set forth in 36 CFR Part 60. In my opinion, the property meets does not meet the National Register criteria. See continuation sheet.

Signature of certifying official [Signature] Date 3-22-90

State or Federal agency and bureau _____

In my opinion, the property meets does not meet the National Register criteria. See continuation sheet.

Signature of commenting or other official _____ Date _____

State or Federal agency and bureau _____

5. National Park Service Certification

I, hereby, certify that this property is:

entered in the National Register.
 See continuation sheet.

determined eligible for the National Register. See continuation sheet.

determined not eligible for the National Register.

removed from the National Register.

other, (explain:) _____

Signature of the Keeper

Date of Action

6. Function or Use

Historic Functions (enter categories from instructions)

EDUCATION/ Education-related housing

Current Functions (enter categories from instructions)

EDUCATION/ Education-related housing**7. Description**

Architectural Classification

(enter categories from instructions)

Mission/Spanish Colonial Revival

Materials (enter categories from instructions)

foundation Concretewalls Brickroof Ceramic Tileother Limestone**Describe present and historic physical appearance.**

The Phi Mu Sorority House is a three-story Spanish Eclectic style building constructed of rough tan and orange brick in common bond. To the immediate west is a building of similar size and use; otherwise the neighborhood contains predominately single-family residential dwellings, with some multi-family conversions and scattered Greek Letter Society dwellings. The exterior, with the exception of some sympathetic window replacements on the upper floors, retains a high degree of integrity. The important interior public spaces are generally intact, with the exception of modern ceiling and wall materials in the foyer, and den and a drop ceiling in the dining room. The nomination consists of one contributing building which represents the property type "Fraternity or Sorority House," defined in the Multiple Property Listing of Fraternity and Sorority Houses at the Urbana-Champaign Campus of the University of Illinois.

Exterior

The Phi Mu Sorority House is situated mid-block, facing Ohio Street, and is linear in plan with a central three-story, side-gabled section flanked by two-story, side-gabled sections. While flush across the main facade, the sections are distinct visual units defined by prominent down spouts and different fenestration patterns. The walls are of tan and orange rough brick laid in common bond. The first story of the main (south) facade's central section focuses upon an arcaded, raised, tile-roofed porch with three arched openings to the front and one on each side. The arches are connected by original decorative iron balustrades. On either side of the central front door is a small decorative arch made of header course bricks slightly projecting from the wall. Flanking the porch are two paired-arch leaded-glass windows separated by engaged spiral Corinthian columns of limestone. Above each window pair is a square glazed tile with elaborate blue and yellow patterns.

 See continuation sheet

United States Department of the Interior
National Park Service

National Register of Historic Places Continuation Sheet

Phi Mu Sorority House, Urbana, Champaign Co., IL

Section number 7 Page 2

The second floor of the central section has five pairs of three-light, dark metal, casement windows with snap-on mullions. These windows are sympathetic in color and mullion pattern with the originals and are typical of most upper story windows in the building. The third story has no windows on the main facade, but instead has five criss-cross pattern wooden frieze grilles, each approximately one half the size of the second floor window pairs. The roof of this section, as on the entire building, consists of blue, orange and brown, straight barrel, mission tiles. A large chimney dominates the west edge of the central section, and has decorative brick stepping up to a flared top with a tile hipped cap. Rafters are exposed on slightly overhanging eaves on the north and south facades.

Surrounding the entire central section and part of the east section along the main facade is a five foot high brick wall, enclosing a large brick patio. The south wall of the enclosure is slightly lower than the east and west walls and has ceramic tile coping. The sidewalk from the street passes through an opening in the wall flanked by two brick piers. Connecting them are two wrought iron pieces with spiral ends joined to form an archway. On the inside east and west walls of the courtyard are two arched insets with elaborately decorated blue, yellow and white glazed tiles. On either side of the insets are plain brick piers flanked by square ornamental perforations.

The two-story west section of the building features a small campanile on the southwest corner, which projects several feet above the eaves. The top is open with paired arches on three sides, surmounted by a pyramidal tile roof. The south facade has two French doors on the first story with two sets of paired casement windows above. The building's east section has a more irregular fenestration pattern with small arched and flat casement windows, one of which is covered by a decorative iron grille.

The west elevation continues the pattern of French doors on the first story and paired casements above. Centered on the second story is an arched casement window pair with original three-light glass. The east elevation consists of paired casement windows and a metal fire escape (probably original) toward the north. The north (rear) elevation has original arched and flat casement windows on the first story and flat paired casements on the second and third stories (mostly replacements.) Paired arched windows separated by simple limestone piers are centered

United States Department of the Interior
National Park Service

National Register of Historic Places Continuation Sheet

Phi Mu Sorority House, Urbana, Champaign Co., IL

Section number 7 Page 3

just below the second and third floors. A metal fire escape (probably original) is attached to the west end of the central three-story section.

Interior

The main entry is through the large (original) wooden door on the building's south side, which features a small eight-point, star-shaped window. An entry hall runs from south to north the entire depth of the building, accessing the den and secondary hallway to the east, the stairwell toward the north wall, and the living room to the west. Modern paneling, ceiling and floor materials cover the hall, except for a four foot by seven foot section of floor near the front door, which has pentagonal glazed tiles of various earth tones.

Retaining a high degree of integrity, the living room is divided into two parts by a large double-sided fireplace consisting of engaged Corinthian columns supporting a sloping plaster hood. Flanking the fireplace are two Spanish sconces and two broad doorways with concave notched corners and a gently curved top. A recessed area identical in style to the doorways surrounds a trophy case in the eastern most wall of the living room. The west and south living room walls have original ten-light double sash doors with three-light arched windows above, which open onto simulated balconettes with iron railings flush against the outside walls. The middle door on the west wall opens onto a small concrete landing with steps leading down to the driveway. Both the east and west living room areas have ornate Spanish-style chandeliers centered in the plaster ceilings.

The western half of the first floor contains a den with modern paneling and several small offices and storage rooms. The stairs to the north lead to the basement and to the upper floor dormitory areas. The original staircase remains intact, with its Spanish style iron balustrade.

The basement level contains the dining room, also reflecting Spanish influence with its stucco walls lined with wrought iron sconces. Adjacent are a pool room and lounge, both with modern paneled walls. The kitchen is to the north. To the immediate west of the stairs are a boiler room and small game room, which has original plaster wall and ceiling materials and original wooden baseboards. The floor plan arrangement has remained unchanged throughout the house.

United States Department of the Interior
National Park Service

National Register of Historic Places
Continuation Sheet

Phi Mu Sorority House, Urbana, Champaign Co., IL

Section number 7 Page 4

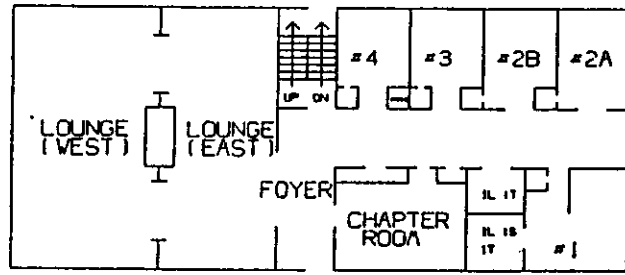

First Floor

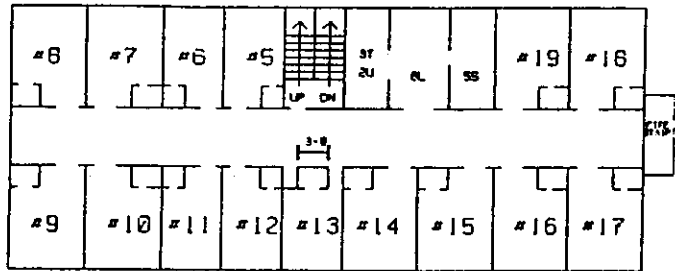

Second Floor

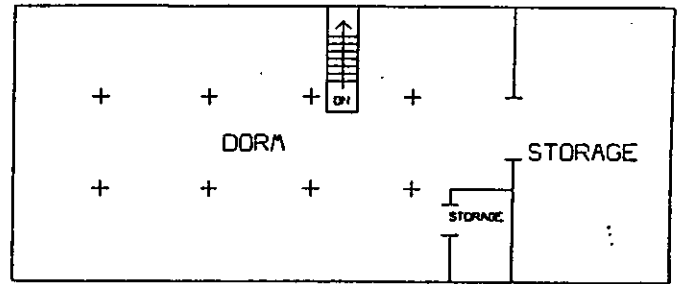

Third Floor

8. Statement of Significance

Certifying official has considered the significance of this property in relation to other properties:

 nationally statewide locallyApplicable National Register Criteria A B C DCriteria Considerations (Exceptions) A B C D E F G

Areas of Significance (enter categories from instructions)

EducationArchitecture

Significant Person

N/A

Period of Significance

1928 - 1940

Significant Dates

1928

Cultural Affiliation

N/A

State significance of property, and justify criteria, criteria considerations, and areas and periods of significance noted above.

The Phi Mu Sorority House is significant as a facility meeting the registration requirements of the property type "Fraternity or Sorority House" as defined in the approved Multiple Property Documentation Form, Fraternity and Sorority Houses at the Urbana-Champaign Campus of the University of Illinois. The Phi Mu Sorority House is an excellent representation of the Greek Letter Society movement at the Urbana-Champaign campus of the University of Illinois, which by 1928 was the largest such movement in the nation. The fraternity and sorority houses spawned by this movement contributed much to the broad patterns of higher education on the Urbana-Champaign campus by becoming the predominant form of organized student housing on campus, by providing a setting for social growth and leadership, and by reflecting the enduring American interest in classical culture (Criterion A). Integrity of design has been maintained with no exterior additions or significant changes in materials, other than some sympathetic window replacements on the upper stories. Although some changes in materials have been made to the interior, the floor plan remains unaltered, and prominent public spaces such as the two-part living room, staircase, and much of the dining room retain a high degree of integrity. The Phi Mu Sorority House is also significant architecturally, being an excellent example of the Spanish Eclectic style and the finest example of this style at the Illinois campus (Criterion C). The building possesses many unusually refined exterior Spanish details, all of which are in excellent condition. As part of an active fraternity on the University of Illinois campus, the significance of the Phi Mu Sorority House continued until 1940, the arbitrary 50-year cut-off date.

 See continuation sheet

United States Department of the Interior
National Park Service

National Register of Historic Places Continuation Sheet

Phi Mu Sorority House, Urbana, Champaign Co., IL

Section number 8 Page 2

Phi Mu Sorority House

Phi Mu was established in 1904 as an outgrowth of a society known as Philomathean, which was founded at Wesleyan College, Macon, Georgia in 1852. It has now grown into one of the largest college organizations for women.

In 1921 the Delta Beta Chapter was established at the University of Illinois. After renting houses in Urbana at 1104 West Illinois Street and at 1008 West Green Street for several years, Phi Mu broke ground in the fall of 1927 for a new house at 706 Ohio Street, Urbana. Built by the Crowl Construction Company at a cost of over \$60,000, the house was completed by the fall of 1928. The house was built through a special system organized by the Crowl Corporation, which operated on numerous college campuses. Crowl provided architectural plans, construction services, and financing for the house. They also prepared a budget for the sorority and organized a schedule of payments. (1)

The 1930s and 1940s were difficult for Phi Mu, as well as most Greek organizations. In 1933 the members of another campus sorority, Alpha Delta Theta, moved into the house at 706 W. Ohio Street, and lived with the Phi Mu's for three years. Later in 1939, the national organizations of Alpha Delta Theta and Phi Mu merged, and those Alpha Delta Theta members who had briefly lived in the Illinois Phi Mu house were officially accepted as Alumnae of Phi Mu. The ceremonies took place at the 706 West Ohio Street house. The members of both sororities were active on campus and were members of the Panhellenic organization. In 1929 the Phi Mu's won the campus-wide singing contest known as the "Shi-ai Sing," which at the time was an important campus event. Like many Greek houses, the Phi Mu house was inactive during World War II. Upon returning, the Phi Mu's occupied temporary quarters and eventually permanent quarters in a new location. (2)

Architecture

The Phi Mu Sorority House is an excellent example of Spanish Eclectic architecture. Virginia and Lee McAlester trace the origins of the Spanish Eclectic style to the 1915 Panama-California Exposition, where the public was exposed to accurate Spanish and Latin American architectural details. American architects began using these details, expanding upon the earlier, less authentic Mission style. While accurate in some details, the Spanish Eclectic style remains eclectic in the composition of

United States Department of the Interior
National Park Service

**National Register of Historic Places
Continuation Sheet**

Phi Mu Sorority House, Urbana, Champaign Co., IL

Section number 8 Page 3

these details, often drawing from the Moorish, Byzantine, Renaissance and Gothic influences on Spanish architecture. The style remained popular from the early 1920s to the early 1940s.

The Phi Mu Sorority House has some outstanding Spanish Eclectic features, especially on its well-detailed exterior. These Spanish Eclectic characteristics include: a side-gabled tile roof with low sections flanking a taller central section; a square corner campanile; a walled patio; an arcaded porch; arched doors; a tile-roof chimney top; casement windows; decorative iron and wood window grilles; brick vents; spiral columns between arched, multi-light windows; ornamental glazed tiles; and decorative iron sconces. The building retains a high degree of integrity, with features from exterior patios and ironwork to interior ceiling fixtures and wall sconces intact.

United States Department of the Interior
National Park Service

National Register of Historic Places Continuation Sheet

Phi Mu Sorority House, Urbana, Champaign Co., IL

Section number 8 Page 4

Chronology of Events

- 1852 Philomathean Society established at Wesleyan College.
- 1904 Phi Mu sorority formed from the Philomathean Society.
- 1921 Delta Beta Chapter established at the University of Illinois.
- 1928 Delta Beta moves into its new house at 706 West Ohio, Urbana.
- 1928-1940 Residents of 706 W. Ohio Street active in the Panhellenic organization and other campus affairs.
- 1933-1935 Local chapter of Alpha Delta Theta sorority moves into 706 W. Ohio Street with the Phi Mu's.
- 1939 The National organizations of Phi Mu and Alpha Delta Theta merge.
- 1941-1945 Delta Beta Chapter inactive during World War II.
- 1946 706 West Ohio Street occupied by Le Treinto Student House.
- 1954 Building occupied by Phi Sigma Delta fraternity.
- 1969-1990 Beta Sigma Psi, a Lutheran fraternity, occupies 706 West Ohio Street.

Endnotes

(1) Letter from Annadell C. Lamb (Phi Mu National Historian), January 14, 1990.

(2) Telephone conversation with Kathryn G. Hansen (class of 1934), February 1, 1990.

9. Major Bibliographical References

The Aglia of Phi Mu. pp. 15-23.

Lamb, Annadell. Letter to Becky Stone. October 23, 1988.

Hansen, Kathryn. Telephone conversation on February 1, 1990.

McAlester, Virginia and Lee. A Field Guide to American Houses. New York: Alfred A. Knopf, 1984.

See continuation sheet

Previous documentation on file (NPS): N/A

preliminary determination of individual listing (36 CFR 67) has been requested

previously listed in the National Register

previously determined eligible by the National Register

designated a National Historic Landmark

recorded by Historic American Buildings

Survey # _____

recorded by Historic American Engineering

Record # _____

Primary location of additional data:

State historic preservation office

Other State agency

Federal agency

Local government

University

Other

Specify repository: _____

10. Geographical Data

Acreeage of property less than one acre

UTM References

A

1	6	3	9	6	3	1	0	4	4	3	9	7	9	0
Zone			Easting				Northing							

B

Zone			Easting				Northing							

C

Zone			Easting				Northing							

D

Zone			Easting				Northing							

See continuation sheet

Verbal Boundary Description

Lot 9 of Fairland Place Subdivision; in the west 1/2 of the northwest 1/4 of Section 18; Township 19N, Range 9E; third Principal Meridian; Champaign County, Illinois.

See continuation sheet

Boundary Justification

The boundary includes the entire city lot that has historically been associated with the property.

See continuation sheet

11. Form Prepared By

name/title Brian Kolde/Preservation Planner
organization The URBANA Group, Inc. date January 1990
street & number 100 S. Race St., P.O. Box 1028 telephone (217) 344-7526
city or town Urbana state IL zip code 61801-9028

The Director of the National Park Service is pleased to inform you that the following properties have been entered in the National Register of Historic Places. For further information call 202/343-1542.

WEEKLY LIST OF LISTED PROPERTIES
5/21/90 1PMRJUGH 5/25/90

JUN 0 1 1990

KEY: Property Name, Multiple Name, Address/Boundary, City,
Vicinity, Certification Date, Reference Number, NHL status

FLORIDA

Marion County
Smith, E. C., House
507 NE. 8th Ave.
Ocala 5/24/90 90000806

GEORGIA

Carroll County
McDaniel--Hule Place
1238 SR 166 W.
Boudon vicinity 5/24/90 90000803

Fulton County

Rock Spring Presbyterian Church
1824 Piedmont Ave. NE.
Atlanta 5/24/90 90000804

ILLINOIS

Champaign County

Alpha Delta Phi Fraternity House
Fraternity and Sorority Houses at the Urbana-Champaign Campu
s of the University of Illinois NPS
310 E. John St.
Champaign 5/21/90 90000752

Delta Upsilon Fraternity House

Fraternity and Sorority Houses at the Urbana-Champaign Campu
s of the University of Illinois NPS
312 E. Armory Ave.
Champaign 5/21/90 90000749

Kappa Delta Rho Fraternity House

Fraternity and Sorority Houses at the Urbana-Champaign Campu
s of the University of Illinois NPS
1110 S. Second St.
Champaign 5/21/90 90000750

Phi Nu Sorority House

Fraternity and Sorority Houses at the Urbana-Champaign Campu
s of the University of Illinois NPS
706 W. Ohio St.
Urbana 5/21/90 90000751

INDIANA

Carroll County
Foreman--Case House
312 E. Main St.
Delphi 5/24/90 90000811

Hamilton County

Craig, William Houston, House
1250 E. Conner St.
Noblesville 5/24/90 90000808

Monroe County

Canal Wax Company Building
211 N. Washington St.
Bloomington 5/24/90 90000812

Randolph County

Kirschbaum, Raphael, Building
NW corner of Columbia and W. Pearl Sts.
Union City 5/24/90 90000813

Rush County

Washington, Booker I., School
614 Fort Wayne Rd.
Rushville 5/24/90 90000809

Tippecanoe County

Upper Main Street Historic District
Roughly bounded by Ferry St., 6th St., Columbia St., and the
Norfolk and Western Railroad tracks
Lafayette 5/24/90 90000814

LOUISIANA

St. Charles Parish
Dorvin House
SR 18 NW of Hahnville
Hahnville vicinity 5/24/90 90000789

MICHIGAN

Genesee County
Genesee County Courthouse and Jail
320 S. Saginaw St.
Flint 5/24/90 90000798

St. Clair County

St. Clair Flats South Channel Range Lights
0.6 mi. W of southern tip of Marsens Island
Algona vicinity 5/24/90 90000853

NEW YORK

Ontario County

Clifton Springs Sanitarium Historic District
E. Main St. between Crane and Prospect
Clifton Springs 5/24/90 90000818

Otsego County

Swart--Wilcox House
Jct. of Wilcox Ave. and Henry St.
Oneonta 5/24/90 90000817

NORTH CAROLINA

Edgecombe County

Worsley--Burnette House
SR 1526 N of jct. with SR 1540
Conetoe vicinity 5/24/90 90000791

PUERTO RICO

San German Municipality

Jaime Acosta y Fores Residence
Calle Dr. Santiago Veve, 70
San German 5/24/90 90000767

UTAH

Utah County

Alpine LDS Church Meetinghouse
Norman Church Buildings in Utah NPS
50 W. Main
Alpine 5/24/90 90000794

VERMONT

Orange County

Mari--Castle
41 S. Main St.
Randolph 5/24/90 90000796

Windham County

Hilldean and Alexander--Davis House
Main St. near town center
Grafton 5/24/90 90000815

Windsor County

Stockbridge Common Historic District
Area around Stockbridge Common, including Maplewood Cemetery
Stockbridge 5/24/90 90000800

Multiple Resource Areas are identified by "RA"
Multiple Property Submissions are identified by "MPS"
Thematic Resources are identified by "TR"
NHL designates a National Historic Landmark

The following actions have been taken on the following properties:

KEY: Property Name, Multiple Name, Address/Boundary, City,
vicinity, Reference Number, NHL status, Requested Action, Decision Date

TENNESSEE

Warren County

McMinnville Hydroelectric Station
Pre-TVA Hydroelectric Development in Tennessee, 1901-1933 N
PS
State Route 55 Bypass at Barnen Fork River
McMinnville 90000807
ADDITIONAL IDENTIFICATION 5/24/90

VERMONT

Windsor County

Bethel Village Historic District (Boundary Increase)
SR 107 across the White R. and N to Central Vermont Railway
tracks
Bethel 90000797
BOUNDARY INCREASE 5/24/90