

United States Department of the Interior
National Park Service

For NPS use only

National Register of Historic Places
Inventory—Nomination Form

received

date entered

See instructions in *How to Complete National Register Forms*
Type all entries—complete applicable sections

1. Name

historic Wright, Dr. Charles M., House

and or common

2. Location

street & number 3 West Jackson Street not for publication

city, town Altamont vicinity of

state Illinois code 012 county Effingham code 049

3. Classification

Category	Ownership	Status	Present Use
<input type="checkbox"/> district	<input type="checkbox"/> public	<input checked="" type="checkbox"/> occupied	<input type="checkbox"/> agriculture
<input checked="" type="checkbox"/> building(s)	<input checked="" type="checkbox"/> private	<input type="checkbox"/> unoccupied	<input type="checkbox"/> commercial
<input type="checkbox"/> structure	<input type="checkbox"/> both	<input type="checkbox"/> work in progress	<input type="checkbox"/> educational
<input type="checkbox"/> site	Public Acquisition	Accessible	<input type="checkbox"/> entertainment
<input type="checkbox"/> object	<input checked="" type="checkbox"/> in process	<input checked="" type="checkbox"/> yes: restricted	<input type="checkbox"/> government
	<input checked="" type="checkbox"/> being considered	<input checked="" type="checkbox"/> yes: unrestricted	<input type="checkbox"/> industrial
		<input type="checkbox"/> no	<input type="checkbox"/> military
			<input type="checkbox"/> museum
			<input checked="" type="checkbox"/> park
			<input type="checkbox"/> private residence
			<input type="checkbox"/> religious
			<input type="checkbox"/> scientific
			<input type="checkbox"/> transportation
			<input type="checkbox"/> other:

4. Owner of Property

name Charles Montague Wright III

street & number 3 West Jackson Street

city, town Altamont vicinity of state Illinois 62411

5. Location of Legal Description

courthouse, registry of deeds, etc. County Clerk's Office

street & number 107 N. Fourth Street

city, town Effingham, state Illinois 62401

6. Representation in Existing Surveys

1. Illinois Historic Structures Survey
title 2. Significant Historical and Architectural Landmarks has this property been determined eligible? yes no

date 1. April 1973 2. 1978 federal state county local

depository for survey records 1. Illinois Historic Preservation Agency
2. South Central Illinois Regional Planning and Development

city, town 1. Springfield
2. Salem state Illinois

7. Description

Condition		Check one	Check one	
<input checked="" type="checkbox"/> excellent	<input type="checkbox"/> deteriorated	<input checked="" type="checkbox"/> unaltered	<input checked="" type="checkbox"/> original site	
<input type="checkbox"/> good	<input type="checkbox"/> ruins	<input type="checkbox"/> altered	<input type="checkbox"/> moved	date _____
<input type="checkbox"/> fair	<input type="checkbox"/> unexposed			

Describe the present and original (if known) physical appearance

The Wright House is an Italianate, two-story L-shaped or asymmetrical structure. The solid brick walls, varying 8 to 13 inches thick, are laid in American bond fashion. There are stone quoins at the corners. The house has a half-hipped dormer breaking into a general hipped roof. The roof has its original, multi-colored slate shingles. There are pedimented dormers with a two-over-two pane configuration located on the north, west and south sides of the roof. A rectangular porch covering the front doors is located on the south side of the southeast corner of the house. Pedimented roofs cover the north and west doors.

The oak-framed windows are in a one-over-one pane configuration. The external window hoods are segmental galvanized iron caps painted a stone grey color. The double front doors are of cherry wood and have rectangular beveled panels with other incised and turned carvings. Above the front doors is a transom with multi-colored glass panes around the border. The name "Wright" is etched in the center, clear panel of glass. The rear door on the north, also of cherry wood, has a similar transom with "1889" etched in the center panel.

The house has three chimneys located in the south, north and west sections of the roof. The chimneys vent the four functional fireplaces and the central heating system. There are three pedimented dormers on the south side of the roof, two on the north side and one on the west side. Decorative exterior elements include a bracketed cornice and twin, two-story bay windows in the southwest quadrant of the house.

The interior of the Wright house has eighteen furnished rooms including seven bedrooms. Upon entering the double front doors, there is a long central hallway with oak flooring. A cherry staircase on the west side leads to the upstairs. There are four functional fireplaces located in the living room, library, dining room and parlor. The ones in the parlor and library have white Italian marble and colorful ceramic tiles around the fireboxes. The overmantels in these two rooms are of cherry wood and have beveled mirrors. The fireplace in the living room is made of Tennessee brown marble with no overmantel. The one in the dining room has Tennessee brown marble, colorful ceramic tiles around the firebox and an oak overmantel with beveled mirrors. There are four non-functional fireplace mantels located in three of the upstairs bedrooms and one in the central downstairs bedroom. They were never intended to be fireplaces but rather decorative elements of these rooms.

All of the woodwork in the eastern section of the house is of cherry wood while the west section is of Wisconsin red oak. The wallpaper in several rooms has been replaced with patterned wallpaper close to the original using period photographs for reference.

During the 1930's the Wright family redecorated for a more modern look. At that time the original wool floral carpeting was replaced with oak hardwood flooring throughout most of the house. Only the northeast corner upstairs bedroom has the original carpeting. The dining room has hard maple and walnut parquet flooring. The light fixtures of brass with porcelain overlay replaced the Victorian cast brass originals. The house still has most of the original furnishings except in the parlor and living room. Each bedroom has its own oak or cherry Eastlake bedroom suite. A simple rococo loveseat and side chair from the 1870's graces the downstairs hallway. They were part of the from the original Wright residence built when the family first moved to Altamont.

**United States Department of the Interior
National Park Service**

**National Register of Historic Places
Inventory—Nomination Form**

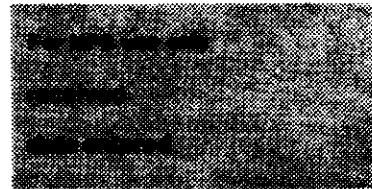

Continuation sheet Dr. Charles M. Wright House Item number 7 Page 2

The full basement is partitioned into rooms following the same floor plan as the first floor. There are two central, load-bearing brick walls forming the walls of some of the rooms. One room is partitioned into oak bins which were used to store fruits and vegetables grown on the Wright property.

There are four of the original outbuildings located to the north and west of the Wright house. These include a barn, summer kitchen, smoke house and coal house. All are constructed of oak and painted grey. The barn, smoke house and coal house are vertically paneled while the summer kitchen is horizontally paneled. The summer kitchen and coal house measure approximately 18' X 24', the smoke house 15' X 18' and the barn 36' X 42'. They range in height from 10' to 25'. A grove of trees lies behind the house.

8. Significance

Period	Areas of Significance—Check and justify below			
___ prehistoric	___ archeology-prehistoric	___ community planning	___ landscape architecture	___ religion
___ 1400-1499	___ archeology-historic	___ conservation	___ law	___ science
___ 1500-1599	___ agriculture	___ economics	___ literature	___ sculpture
___ 1600-1699	<input checked="" type="checkbox"/> architecture	___ education	___ military	<input checked="" type="checkbox"/> social/
___ 1700-1799	___ art	___ engineering	___ music	humanitarian
<input checked="" type="checkbox"/> 1800-1899	___ commerce	___ exploration/settlement	___ philosophy	___ theater
___ 1900-	___ communications	___ industry	___ politics/government	___ transportation
		___ invention		___ other (specify)

Specific dates 1889 **Builder/Architect** Charles Hanker, contractor from Cumberland county, Illinois

Statement of Significance (in one paragraph) Charles H. Spilman, architect from Edwardsville, Illinois

Charles Montague Wright I decided to build his single family residence in 1888. The family's existing two-story frame residence, circa 1871, was moved from the site directly east across the street to the corner lot. The Wright family continued to live in the frame home while the new brick Italianate was under construction on its previous site. The materials, labor and furnishings totaled \$35,000 for the new home.

Before actual construction on the Wright house began, Charles Wright I thoroughly researched building styles, furnishings and materials using bound volumes of Scientific American and other periodicals. Charles Spilman, a doctor by profession before becoming an architect, submitted a 28-page hand-written document specifying all materials and building techniques. Mr. Wright made notes in the margin specifying sources for the materials and furnishings. Mr. Spilman later designed Queen Anne homes in the Edwardsville, Illinois area. He had probably suggested the Italianate design to Mr. Wright just three to four years earlier. His main architectural achievements were grain elevators in Kansas City, Missouri and in Indiana. The Edwardsville Historic Preservation Commission concluded in its St. Louis Street Historic District nomination that Spilman's training as a doctor gave him an understanding of internal structure in relationship to the total strength of a structure. He used this understanding on his mills, bridges, public buildings and homes.

The Wright house satisfies criterion C of the National Register as the prime example of Italianate architecture in Effingham county. There are three other extant Italianate buildings in Effingham: (1) the train station at 607 S. Banker, (2) Wiedman's Cleaners at 106 E. Washington and (3) a residence zoned commercially at 401 E. Jefferson. A fourth building located at 210 W. Jefferson now has the entire building encased in a decorative concrete facade.

The Wright House also satisfies criterion A because the house has descended in the Wright family since 1889 to its present owner, Charles M. Wright III. The Wright family helped settle the village of Altamont in 1870. This followed the general pattern of westward migration since the Wright family had moved from Ohio some years before.

Dr. Wright I attended the Eclectic Medical College of Pennsylvania in Philadelphia, graduating in 1857. That same year he moved to Ewington, Illinois, located on the Old National Road four miles west of Effingham. Ewington was then the Effingham county seat. There Dr. Wright practiced medicine with Dr. John LeCrone for one year. Then he moved to Freemanton, located on the Old National Road six miles west of Ewington. There he was the only doctor, serving the medical needs of most of the families in western Effingham county. When the Terre Haute, Vandalia and St. Louis railroad was completed, small villages like Ewington and Freemanton declined and disappeared. Dr. Wright moved his family and medical practice in 1870 to the newly-established village of Altamont, located

**United States Department of the Interior
National Park Service**

**National Register of Historic Places
Inventory—Nomination Form**

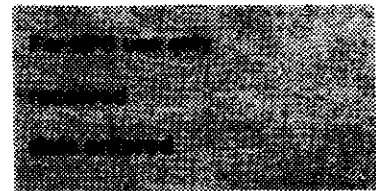

Continuation sheet Dr. Charles M. Wright House Item number

8

Page 2

three miles west of Freemanton on the Old National Road which is now U.S. Highway 40. He built a two-story, frame residence on north Main Street at the edge of the village. He also erected a two-story frame building on the north-west corner of north Main Street and what is now west Jefferson Street. This building served as his medical office. The second floor of the building had a meeting hall with a stage in one end. This served as the Wright Opera House where many of Altamont's civic and school gatherings took place.

Dr. Wright I retired from his medical practice in 1878. He established a bank in his medical building which operated until 1894. This private bank was, during a part of that time, Altamont's only bank. His son, Charles M. Wright II, graduated from medical school at Washington University in St. Louis, Missouri. Charles Wright II practiced medicine in his father's medical building from 1902 to 1967 when he retired. The building was razed in 1972 and a modern law office building was erected on its site.

The second Dr. Wright served the Altamont community not only as a physician but also as health commissioner, member of the public school boards for both the elementary and secondary districts, and as an elder of the Presbyterian Church. Mrs. Wright, an accomplished pianist and vocalist, was prominent in Altamont's musical activities.

The Wright House is now occupied and owned by Charles M. Wright III, who was a corporate lawyer with Shell Oil Company and is now retired. He returned to Altamont in 1977 to reside in the community which his family helped to settle, serve in medicine, practice banking, serve the community's schools, church and musical activities for 97 years. The Wright House graces the community as its largest and finest residence.

9. Major Bibliographical References

History of Effingham County, Illinois, 1883
28 page hand written specifications for Charles M. Wright I
County clerk's record of property transaction
Bond and contract agreement between Mr. Wright and Mr. Spilman
History of the Wright House prepared by Charles M. Wright III

10. Geographical Data

Acreeage of nominated property 3.0

Quadrangle name Altamont East Quadrangle

Quadrangle scale 1:24000

UTM References

A

--	--	--	--	--	--	--	--	--	--

Zone Easting Northing

B

--	--	--	--	--	--	--	--	--	--

Zone Easting Northing

C

--	--	--	--	--	--	--	--	--	--

D

--	--	--	--	--	--	--	--	--	--

E

--	--	--	--	--	--	--	--	--	--

F

--	--	--	--	--	--	--	--	--	--

G

--	--	--	--	--	--	--	--	--	--

H

--	--	--	--	--	--	--	--	--	--

Verbal boundary description and justification

The nominated property occupies lot number 8 east half of Block number 8 of the platted Town of Altamont with an additional 2.0 acres for a total of 3.0 acres. It is in section 9 of Mound township.

List all states and counties for properties overlapping state or county boundaries

state code county code

state code county code

11. Form Prepared By

name/title Charles Philip Lewis

organization

date December 27, 1985

street & number 608 W. Fayette

telephone 217-342-6280

city or town Effingham

state Illinois 62401

12. State Historic Preservation Officer Certification

The evaluated significance of this property within the state is:

national state local

As the designated State Historic Preservation Officer for the National Historic Preservation Act of 1966 (Public Law 89-665), I hereby nominate this property for inclusion in the National Register and certify that it has been evaluated according to the criteria and procedures set forth by the National Park Service.

State Historic Preservation Officer signature

title

date

For NPS use only

I hereby certify that this property is included in the National Register

date

Keeper of the National Register

Attest:

date

Chief of Registration

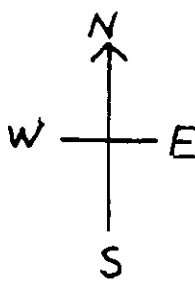
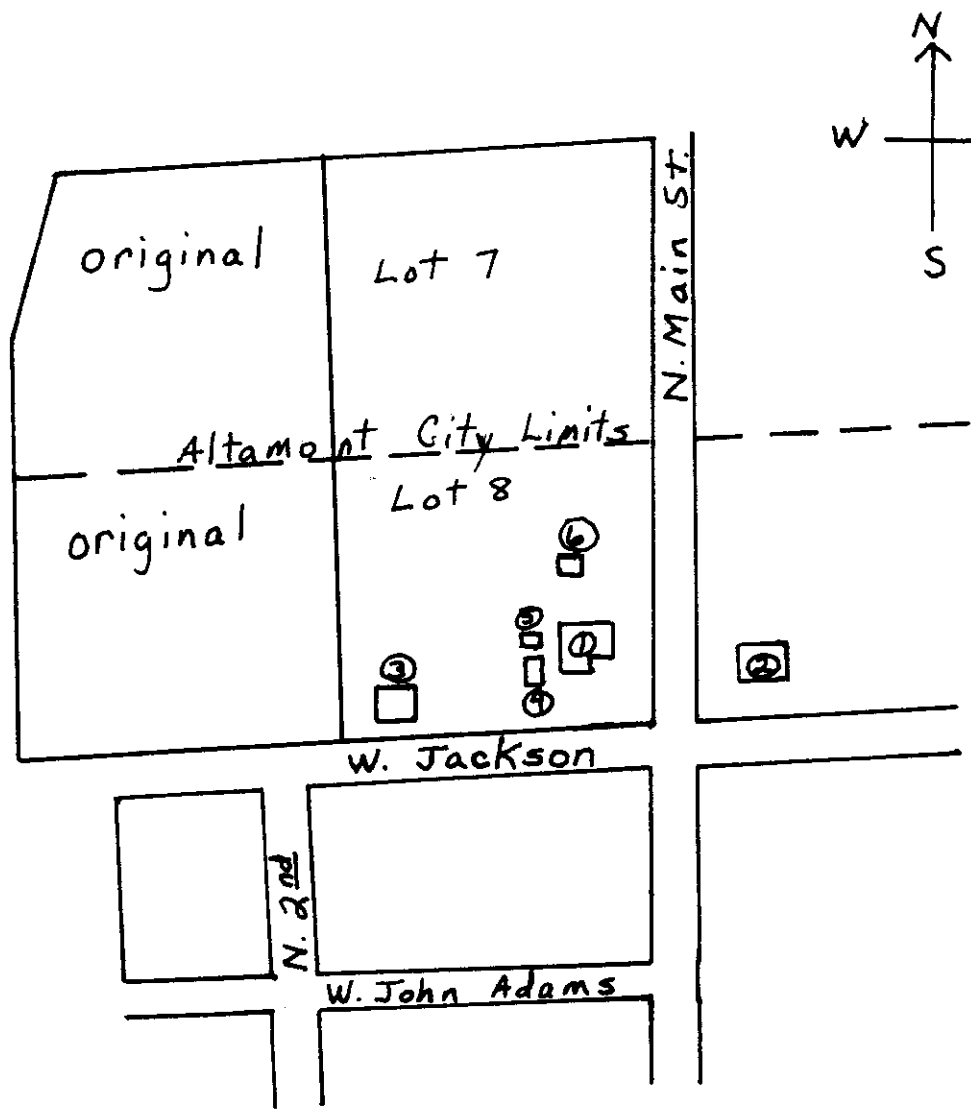

1 in. = 300'

- ① Wright House
- ② Original Wrig House
- ③ barn
- ④ Summer Kitch
- ⑤ smoke house
- ⑥ coal house



IN REPLY REFER TO:

United States Department of the Interior

NATIONAL PARK SERVICE

P.O. BOX 37127

WASHINGTON, D.C. 20013-7127

MAY 15 1986

The Director of the National Park Service is pleased to inform you that the following properties have been entered in the National Register of Historic Places beginning May 4, 1986 and ending May 10, 1986. For further information call (202) 343-9552.

STATE, County, Vicinity, Property, Address, (Date Listed)

- ALABAMA, Choctaw County, Mount Sterling, Mount Sterling Methodist Church, Near jct. of CR 43 and CR 27 (05/08/86)
- ALABAMA, Colbert County, Leighton, Preuit Oaks, Cotton Town Rd. (05/08/86)
- ALABAMA, DeKalb County, Fort Payne, Alabama Builders' Hardware Manufacturing Company, 204 Eighth St. NE (05/08/86)
- ALABAMA, Etowah County, Gadsden, Hood, Colonel O. R., House, 862 Chestnut St. (05/08/86)
- ALABAMA, Marshall County, Arab, Hotel Thompson, 104 First Ave. NE (05/08/86)
- CALIFORNIA, San Francisco County, San Francisco, Ship KING PHILIP—Schooner REPORTER (Shipwreck Site), Foot of Ortega St. (05/08/86)
- DELAWARE, New Castle County, Townsend, Townsend Historic District, Roughly bounded by Taylor, Main, Commerce, Lattiamus, South, Ginn, and Walnut Sts., Railroad Ave., and Cannery Ln. (05/08/86)
- GEORGIA, Stewart County, Richland, Richland Historic District, Roughly bounded by Ponder and Harmony Sts., GA 27 and Broad St. (05/05/86)
- ILLINOIS, Cook County, Chicago, Blackstone Hotel, 80 E. Balbo Dr. (05/08/86)
- ILLINOIS, Cook County, Chicago, Jeffery—Cyril Historic District, 7146—7148, 7128—7138 Cyril Ave., 7144—7148, 7147, & 7130 S. Jeffery Blvd., and 1966—1974 E. Seventy-first Pl. (05/05/86)
- ILLINOIS, Cook County, Lemont, Lemont Methodist Episcopal Church, 306 Lemont St. (05/05/86)
- ILLINOIS, Effingham County, Altamont, Wright, Dr. Charles M., House, 3 W. Jackson St. (05/08/86)
- ILLINOIS, Jersey County, Jerseyville, Jersey County Courthouse, Public Square (05/08/86)
- ILLINOIS, Kane County, Aurora, Aurora Watch Factory, 603—621 LaSalle St. (05/08/86)
- ILLINOIS, Mercer County, Keithsburg, Keithsburg Historic District, Roughly bounded by Third, Jackson, Fifth, and Washington Sts. (05/08/86)
- KENTUCKY, Elliott County, Conley—Greene Rockshelter (15EL4) (05/08/86)
- LOUISIANA, Terrebonne Parish, Gibson, Gibson Methodist Episcopal Church, S. Bayou Black Dr. (05/09/86)
- MAINE, Aroostock County, Presque Isle, U.S. Post Office—Presque Isle Main, 23 Second St. (05/09/86)
- MAINE, Cumberland County, Portland, U.S. Post Office—Portland Main, 125 Forest Ave. (05/09/86)
- MARYLAND, Howard County, Ellicott City vicinity, Enniscorthy, 3412 Folly Quarter Rd. (05/08/86)
- MASSACHUSETTS, Hampshire County, Ware, Ware Center Historic District, MA 9 and Greenwich Plains Rd. (05/08/86)